

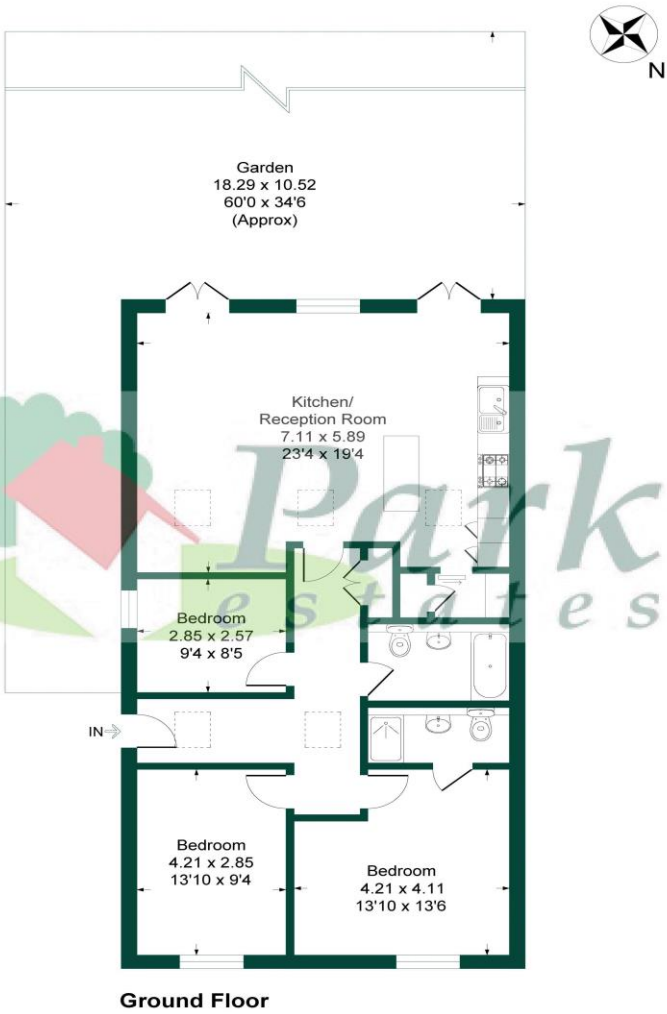

**Manor Freehold Farm, Parsonage Lane, DA14**  
Approximate Gross Internal Area = 103.6 sq m / 1116 sq ft



This plan is for layout guidance only. Not drawn to scale unless stated. Windows and door openings are approximate. Whilst every care is taken in the preparation of this plan, please check all dimensions, shapes and compass bearings before making any decisions reliant upon them.  
Produced By Planpix





Manor View Farm is a stunning gated development of 4 new build contemporary detached barns located in a unique country lane and rural setting on the Bexley/Sidcup borders. Very careful consideration has been given to the interior and exterior design and build which is in keeping with the area and includes a zinc roof and rainwater goods, composite cladding and black heritage double glazed windows and doors to create a lovely living space with highest level of finish and specification throughout. The light and spacious accommodation comprises of large open plan living and bespoke fully fitted area with a fully removable island unit and heritage French doors to the garden, utility room, 3 large bedrooms, beautiful ensuite shower room and bathroom both with very high quality fittings and a superb micro plaster finish. Externally there is a 60' approx landscaped rear garden and a spacious frontage with an EV charger point and ample parking for more than 4 cars. Other features to note include tiled flooring with a wet underfloor electric ECO heating system and a STROMA 10 year warranty. Your earliest viewing would be very highly recommended.

Local Authority: Bexley

